

CORNER RESTORATION

CORNER: N1/4 SEC. 31, TWP. 7 S., RANGE 28 E., W.M.

ORIGINAL SURVEY BY: Frank W. Campbell

CONTRACT NUMBER: 521

CONTRACT DATE: January 8, 1885

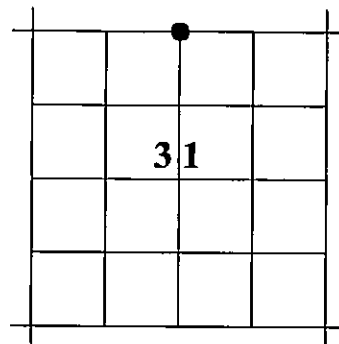

SUBSEQUENT SURVEYS:

► By Robert D. Bagett, Grant County Surveyor in 1994

ORIGINAL GLO DESCRIPTION: Set a basalt stone 15x8x7 ins. 10 ins. in the ground for 1/4 sec. cor. marked 1/4 on N. face and raised a mound of stone alongside.

► 1994 BAGETT'S DESCRIPTION: Found a basalt stone 14"x8"x6" in a mound of stone marked 1/4 on one face. . . I set a 1 1/2"x30" galv. iron pipe 26" in the ground with attached Grant County Surveyor brass cap, marked as shown. From which I scribe new bearing trees: A juniper 7" diam. bears N41°E, 129.3 ft. marked 1/4 S30 CSBT; A juniper 7" diam. bears S64°E, 49.7 ft. marked 1/4 S31 CSBT; A juniper 7" diam. bears N81°W, 113.2 ft. marked 1/4 S30 CSBT; I set a new reference point: a 5/8"x30" iron pin with bears S45°W, 25.00 ft., with attached alum. cap marked GRANT COUNTY SURVEYOR RP1 1994 OPLS 598

EVIDENCE FOUND AND NEW ACCESSORIES: Found the brass cap monument set by Bagett in 1994. The monument is in good condition in a 4 ft. mound of stone. Also found the reference point set by Bagett in good condition. We placed a fiberglass location post about 2 ft. East of mound of stone.

The bearing trees are all in good health with partially healed blazes and visible scribing. We reattached the BT tags to the bearing trees and measured the diameters of the bearing trees scribed by Bagett in 1994. New diameters are as follows:

Northeast BT is now 9 1/2" diam.

Southeast BT is now 8" diam.

Northwest BT is now 9" diam.

STATE PLANE COORDINATES (3601 OR N)

Reference Datum: NAD83 From OPUS solution

Northing: 460,988.5 ft.

Easting: 8,482,472.6 ft.

Ellip. Ht: 2,294.2 ft.

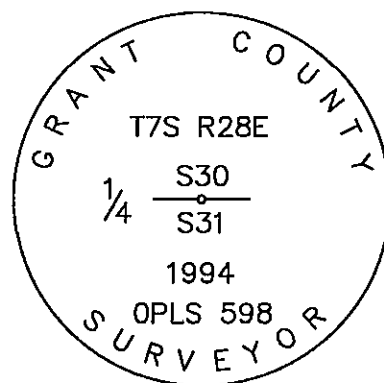

RESTORATION BY, STAMP AND DATE:

Michael C. Springer, PLS, Grant County Surveyor

Jason L. Hatfield, PLS, Deputy County Surveyor

Surveyed November 15, 2012

RECEIVED AND FILED
GRANT COUNTY SURVEYOR

NOV 16 2012

BY: 

REGISTERED
PROFESSIONAL
LAND SURVEYOR

OREGON
JULY 9, 2002
MICHAEL C. SPRINGER
#70918

EXPIRES: 6/30/2014